

### GN SERIES

#### Front mount

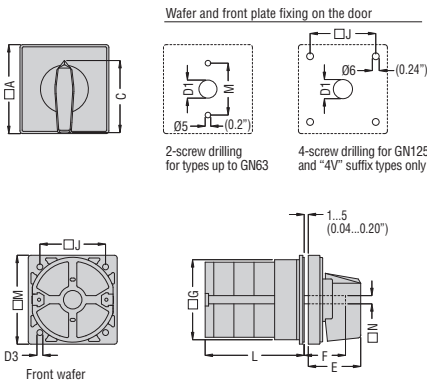

Type	Dimensions											L					
	A	C	D1	D3	E	F	G	J	M	N		1 wafer	2 wafers	3 wafers	4 wafers	5 wafers	6 wafers
GN12	48 (1.89)	39.5 (1.55)	12 (0.47)	4.3 (0.17)	26.5 (1.04)	23.5 (0.92)	39 (1.53)	36 (1.42)	48 (1.89)	6 (0.24)		36.1 (1.42)	45.8 (1.80)	55.5 (2.18)	65.2 (2.57)	74.9 (2.95)	84.6 (3.33)
GN12Ⓢ	65 (2.56)	53 (2.09)	14 (0.55)	4.3 (0.17)	34.5 (1.36)	26 (1.02)	58 (2.28)	48 (1.89)	65 (2.56)	7 (0.27)		36.6 (1.44)	46.3 (1.82)	56 (2.20)	65.7 (2.59)	75.4 (2.97)	85.1 (3.35)
GN20	48 (1.89)	39.5 (1.55)	12 (0.47)	4.3 (0.17)	26.5 (1.04)	23.5 (0.92)	39 (1.53)	36 (1.42)	48 (1.89)	6 (0.24)		36.1 (1.42)	45.8 (1.80)	55.5 (2.18)	65.2 (2.57)	74.9 (2.95)	84.6 (3.33)
GN20Ⓢ	65 (2.56)	53 (2.09)	14 (0.55)	4.3 (0.17)	34.5 (1.36)	26 (1.02)	58 (2.28)	48 (1.89)	65 (2.56)	7 (0.27)		36.6 (1.44)	46.3 (1.82)	56 (2.20)	65.7 (2.59)	75.4 (2.97)	85.1 (3.35)
GN25	48 (1.89)	39.5 (1.55)	12 (0.47)	4.3 (0.17)	26.5 (1.04)	23.5 (0.92)	39 (1.53)	36 (1.42)	48 (1.89)	6 (0.24)		40.5 (1.59)	54.1 (2.13)	67.7 (2.66)	81.3 (3.20)	94.9 (3.74)	108.5 (4.27)
GN25Ⓢ	65 (2.56)	53 (2.09)	14 (0.55)	4.3 (0.17)	34.5 (1.36)	26 (1.02)	58 (2.28)	48 (1.89)	65 (2.56)	7 (0.27)		41 (1.61)	54.6 (2.15)	68.2 (2.68)	81.8 (3.22)	95.4 (3.75)	109 (4.29)
GN32	65 (2.56)	53 (2.09)	14 (0.55)	4.3 (0.17)	34.5 (1.36)	26 (1.02)	58 (2.28)	48 (1.89)	65 (2.56)	7 (0.27)		46.5 (1.83)	61.6 (2.442)	76.7 (3.02)	91.8 (3.61)	106.9 (4.21)	122 (4.80)
GN40	65 (2.56)	53 (2.09)	14 (0.55)	4.3 (0.17)	34.5 (1.36)	26 (1.02)	58 (2.28)	48 (1.89)	65 (2.56)	7 (0.27)		46.5 (1.83)	61.6 (2.442)	76.7 (3.02)	91.8 (3.61)	106.9 (4.21)	122 (4.80)
GN63	65 (2.56)	53 (2.09)	14 (0.55)	4.3 (0.17)	34.5 (1.36)	26 (1.02)	62 (2.44)	48 (1.89)	65 (2.56)	7 (0.27)		50.3 (1.98)	68.4 (2.69)	86.5 (3.40)	104.6 (4.12)	122.7 (4.83)	140.8 (5.54)
GN125	90 (3.54)	70.5 (2.77)	16 (0.63)	5.3 (0.21)	41.5 (1.63)	28 (1.10)	84 (3.31)	68 (2.68)	90 (3.54)	9 (0.35)		67.3 (2.65)	96.4 (3.79)	125.5 (4.94)	154.6 (6.09)	183.7 (7.23)	212.8 (8.38)

Ⓢ Dimensions for U06 and U25 versions

#### Door coupling

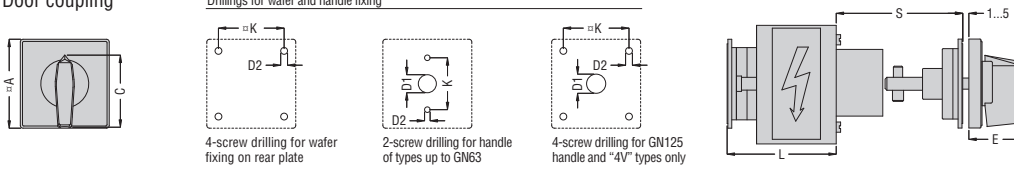

Type	Dimensions						L				
	A	C	D1	D2	E	K	S	1 wafer	2 wafers	3 wafers	4 wafers
GN12-088	65 (2.56)	53 (2.09)	14 (0.55)	5 (0.20)	38.5 (1.52)Ⓢ	48 (1.89)	45-55 (1.77"-2.16")	37.58 (1.48")	47.1 (1.85")	56.7 (2.23")	66.3 (2.61")
GN20-088	65 (2.56)	53 (2.09)	14 (0.55)	5 (0.20)	38.5 (1.52)Ⓢ	48 (1.89)	45-55 (1.77"-2.16")	38.1 (1.50")	47.8 (1.88")	57.5 (2.26")	67.2 (2.64")
GN25-088	65 (2.56)	53 (2.09)	14 (0.55)	5 (0.20)	38.5 (1.52)Ⓢ	48 (1.89)	45-55 (1.77"-2.16")	42.5 (1.67")	56.1 (2.21")	65.7 (2.59")	83.2 (3.27")
GN12-068	48 (1.89)	39.5 (1.56)	12 (0.47)	5 (0.20)	26.5 (1.04)	36 (1.42)	45-55 (1.77"-2.16")	37.5 (1.48")	47.1 (1.85")	56.7 (2.23")	66.3 (2.61")
GN20-068	48 (1.89)	39.5 (1.56)	12 (0.47)	5 (0.20)	26.5 (1.04)	36 (1.42)	45-55 (1.77"-2.16")	38.1 (1.50")	47.8 (1.88")	57.5 (2.26")	67.2 (2.64")
GN25-068	48 (1.89)	39.5 (1.56)	12 (0.47)	5 (0.20)	26.5 (1.04)	36 (1.42)	45-55 (1.77"-2.16")	42.5 (1.67")	56.1 (2.21")	65.7 (2.59")	83.2 (3.27")
GN32 0...	65 (2.56)	53Ⓢ (2.09)	14 (0.55)	5 (0.20)	34.5 (1.36)Ⓢ	48 (1.89)	45-55 (1.77"-2.16")	49.2 (1.94")	62.8 (2.47")	76.4 (3.00")	90 (3.54")
GN40 0...	65 (2.56)	53Ⓢ (2.09)	14 (0.55)	5 (0.20)	34.5 (1.36)Ⓢ	48 (1.89)	45-55 (1.77"-2.16")	45.9 (1.81")	59.5 (2.34")	73.1 (2.88")	86.7 (3.41")
GN63 0...	65 (2.56)	53Ⓢ (2.09)	14 (0.55)	5 (0.20)	34.5 (1.36)Ⓢ	48 (1.89)	45-55 (1.77"-2.16")	54.3 (2.14")	72.4 (2.85")	90.5 (3.56")	108.6 (4.27")
GN125 0...	90 (3.54)	70.5Ⓢ (2.78)	16 (0.63)	6 (0.24)	41.5 (1.63)Ⓢ	68 (2.68)	45-55 (1.77"-2.16")	74.8 (2.94")	103.9 (4.09")	133 (5.23")	162.1 (6.38")

- Ⓢ 45 (1.77") for O88 and O98 types
- Ⓢ 65 (2.56") for O99 types
- Ⓢ 38.5 (1.52") for O88 and O98 types
- Ⓢ 49 (1.93") for O99 types
- Ⓢ Paddockable handle.

#### Front ring mount on Ø22mm drilling, 2-screw fixing

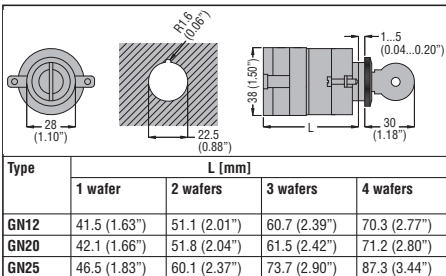

#### Front ring mount on Ø22mm drilling, 2-screw fixing

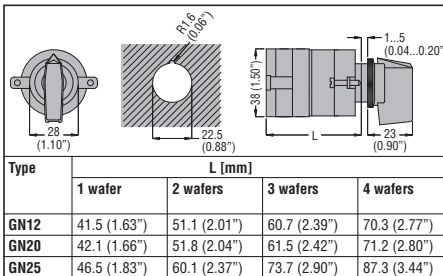

Type	L [mm]			
	1 wafer	2 wafers	3 wafers	4 wafers
GN12	41.5 (1.63)	51.1 (2.01)	60.7 (2.39)	70.3 (2.77)
GN20	42.1 (1.66)	51.8 (2.04)	61.5 (2.42)	71.2 (2.80)
GN25	46.5 (1.83)	60.1 (2.37)	73.7 (2.90)	87.3 (3.44)

Type	L [mm]			
	1 wafer	2 wafers	3 wafers	4 wafers
GN12	41.5 (1.63)	51.1 (2.01)	60.7 (2.39)	70.3 (2.77)
GN20	42.1 (1.66)	51.8 (2.04)	61.5 (2.42)	71.2 (2.80)
GN25	46.5 (1.83)	60.1 (2.37)	73.7 (2.90)	87.3 (3.44)

#### Mounting in enclosure

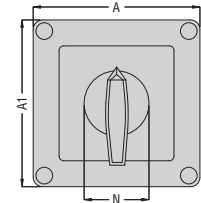

#### Drilling for enclosure fixing

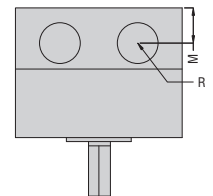
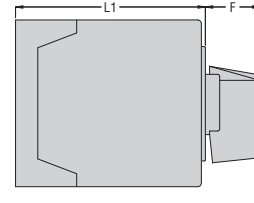
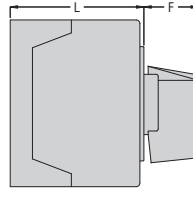
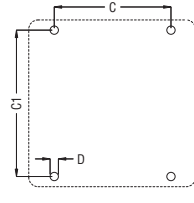

Type	Enclosure size	N° of wafers		Dimensions											Protection degree	Conduits R
		L	L1	A	A1	C	C1	D	F	M	N	L	L1			
GN12	75x75 (2.95x2.95")	1-2	3-4	75	75	64	50	4.5	19Ⓢ	14	28	57.5	79.8	IP65	4 PG 13.5	
GN20		1-2	3-4	(2.95)	(2.95)	(2.51)	(1.96)	(0.17)	(0.74)	(0.55)	(1.10)	(2.26)	(3.14)			
GN25		1	2-3													
GN20	90x90 (3.54x3.54")	1-3	4-6	90	90	63	79	4.5	25Ⓢ	19	30	71.3	98.3	IP65	4 PG 16	
GN25		1-2	3-4	(3.54)	(3.54)	(2.48)	(3.11)	(0.17)	(0.98)	(0.74)	(1.18)	(2.80)	(3.87)			
GN32		1-2	3-4													
GN40	1	2-3														
GN32	110x110 (4.33x4.33")	1-3	4-5	110	110	98.4	83	4.5	32Ⓢ	21	39.5	85.5	119.5	IP65	4 PG 21	
GN40		1-2	3-4	(4.33)	(4.33)	(3.87)	(3.27)	(0.18)	(1.25)	(0.82)	(1.55)	(3.37)	(4.70)			
GN63		1-2	3-4													
GN125	1	2														

- Ⓢ 28 (1.1") for P25 type with paddockable handle.
- Ⓢ 38.5 (1.52") for P25 type with paddockable handle.